



# Taylor

Collection: The Wellington Collection Floor Plan: Taylor

Square Feet: 1,689 (m.o.l.) Bedrooms: 3 Bathrooms: 2.0 Garage: 2 Car



Elevation A



Elevation B



## TAYLOR OPTIONS

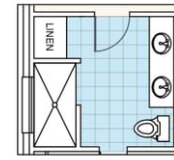

3'X6' DOORLESS SHOWER

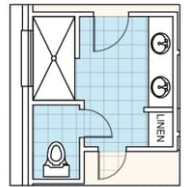

3'X6' DOORLESS SHOWER W/ ENCLOSED WATER CLOSET



LINEN IPO COAT CLOSET



MUD BENCH IPO COAT CLOSET



# Included Features

Collection: The Wellington Collection Floor Plan: Taylor

Square Feet: 1,689 (m.o.l.) Bedrooms: 3 Bathrooms: 2.0 Garage: 2 Car

## Bathroom

\*Price Pfister® bathroom faucet  
Ceramic tile floor in baths  
Light in master bathroom showers  
Italian Marble on Vanities (homes permitted after 11-1-2020)

Fiberglass shower / tub combo in hall bath  
Framed mirror  
Tiled shower and garden tub in master bath  
\*Schluter-KERDI Shower System

## Interior Finishes

3 1/4" paint grade baseboard  
Garage door opener with 2 remotes (2-car garages only)  
4 1/4" paint grade crown molding (in selected areas per plan)  
Ceramic tile floors in entry  
Enhanced light package with light fixture and door hardware (oil rubbed bronze or satin nickel)  
Hand textured walls  
Raised 10' ceiling in living areas and master bedrooms (in single story plan)  
Finished 2-car garage with wind resistant steel insulated garage door  
Double or Single French Back Door with Built-in Blinds  
2 Electrical outlets w/dual USB port (kitchen & master bedroom)  
Combo flooring- Ceramic tile floors in select areas and wall-to-wall plush cut loop berber carpet with 1/2" 6 lb pad in select areas

Interior doors (panel style may vary)  
Box rated for ceiling fans in all other bedrooms  
Insulated entry door (panel style may vary)  
Pull-down attic access in garage (in single story plan)  
Light fixture package (includes wiring & installation)  
Ceiling fans in living room and master bedroom  
\*Filtrete™ Air Filtration Systems  
Bullnose corners (vary per plan)  
LED lights throughout  
Overhead cabinet, shelf and clothing rod in utility room  
Ventless gas log fireplace

## Energy-efficiency

97% efficient tankless water heater  
Low-e Thermalpane tilt-in vinyl windows with screen (U-Factors of .35 or less & SHGC Coefficient with argon gas of .26 or less)  
HERS Index Energy Efficiency Rating (every home is tested; score varies per plan & home permit date)  
R-15 blown-in insulation in external walls. Excludes garage  
R-8 Perimeter foam insulation under slab

Radiant Barrier Roof Decking  
R-8 Insulated and mastic sealed A/C ducts  
Polyceal caulking around windows, doors and joints (energy efficient caulking package)  
R-19 batt insulation in sloped ceiling  
Eave roof ventilation  
Gas heating 96% high efficiency furnace and duct work  
R-44 blown-in insulation in attic

## Construction / Plumbing / Electric / Mechanical

Moisture Barrier that lays on top of foundation (homes permitted after 02/01/2020)  
Atlas HP42 130-MPH rated shingles  
Electric dryer connection in utility room  
Category 5 structured wiring  
Protective ground fault interrupter circuits  
\*Uponor AquaPEX tubing for water lines  
Copper electrical wiring

\*Air and moisture barrier DUPONT TYVEK HOMEWRAP with 10-year warranty  
Exterior 2 x 4 stud-grade lumber walls (16" on center)  
Heat-taped condensation lines (attic only)  
16 SEER electrical central air conditioning  
RG6 quad shield cable wiring (at least 4 cable outlets)  
Enhanced modified slab on grade

## Safety

Anchor bolts that secure perimeter walls to foundation  
Tornado Straps that secure perimeter walls to rafters/roof  
Installed smoke detectors  
\*Kwikset Smart Key locks and hardware

Smart Panel Security System  
Oriented Strand Board (OSB) exterior walls  
Carbon Monoxide Sensor  
ToughRock® Fireguard® 45 Gypsum Board sheetrock screwed to studs/walls (exception Barrel Ceilings)

\*Plasma Air 600 series (homes framed after 02/01/2021)

## Exterior Finishes

Concrete patio (vary per plan)  
Minimum of 2 exterior waterproof electrical outlets  
Semi-gloss exterior paint  
Guttering over entry and AC pad (vary per plan)  
Quoin corners in brick work (varies per plan)  
Wellington landscape package

Full Sod (homes sold after 2/5/2021)  
Brick exterior (partial siding on some plans)  
Shutters and/or dormers (vary per plan)  
Brick mailbox with address stone  
\*Two Woodford Freeze-Proof Exterior Water Spigots

## Warranties

Manufacturer's limited appliance warranty  
RWC New Home limited 10-year warranty  
Builder's limited one-year warranty

Manufacturer's limited heating & cooling units warranty  
Termite company's warranty  
Manufacturer's limited lifetime shingle warranty

Buyer's Initials \_\_\_\_\_ Buyer's Initials \_\_\_\_\_ Seller's or its Representative's Initials \_\_\_\_\_

\* Features subject to availability.

Due to constant updates and revisions of our plans, your home may vary slightly from the designs features here. Please consult your New Home Consultant for details.





# Included Features

**Collection:** The Wellington Collection **Floor Plan:** Taylor

**Square Feet:** 1,689 (m.o.l.) **Bedrooms:** 3 **Bathrooms:** 2.0 **Garage:** 2 Car

## Kitchen

LED Under Cabinet Lighting (on selected plans)

1/3 horsepower sink garbage disposal

\*Price Pfister® kitchen faucet

Ceramic tile floor (Kitchen and Dining area)

\*Samsung stainless steel dishwasher, over the range microwave and free-standing gas range (homes permitted after 5/1/2019)

Pendant lights over bar or island (selected plans)

Water line for refrigerator icemaker

3 cm granite or quartz kitchen countertops with tiled backsplash

Flat panel 30" soft-close upper kitchen wood cabinets with European hinges

8" deep under mount kitchen sink (stainless steel)

**Buyer's Initials** \_\_\_\_\_ **Buyer's Initials** \_\_\_\_\_ **Seller's or its Representative's Initials** \_\_\_\_\_

\* Features subject to availability.

Due to constant updates and revisions of our plans, your home may vary slightly from the designs features here. Please consult your New Home Consultant for details.

