



**NEW HOME CONSULTANT**  
**Holly McGowen**  
 (405) 229-7504 Cell Phone  
 (405) 364-9999 Model Home

**Community:** Palermo Place  
**Model:** 14112 Celeste Lane, Oklahoma City, OK  
 73170



**936 SW 139th Street**  
**Oklahoma City, OK 73170**

**SOLD**

Price and availability are subject to change without prior notice. Accurate as of Apr 18, 2021.

- Floor Plan:** Poppy Elite
- Square Feet:** 1,361 (m.o.l.)
- Bedrooms:** 3
- Bathrooms:** 2.0
- Garage:** 2 Car

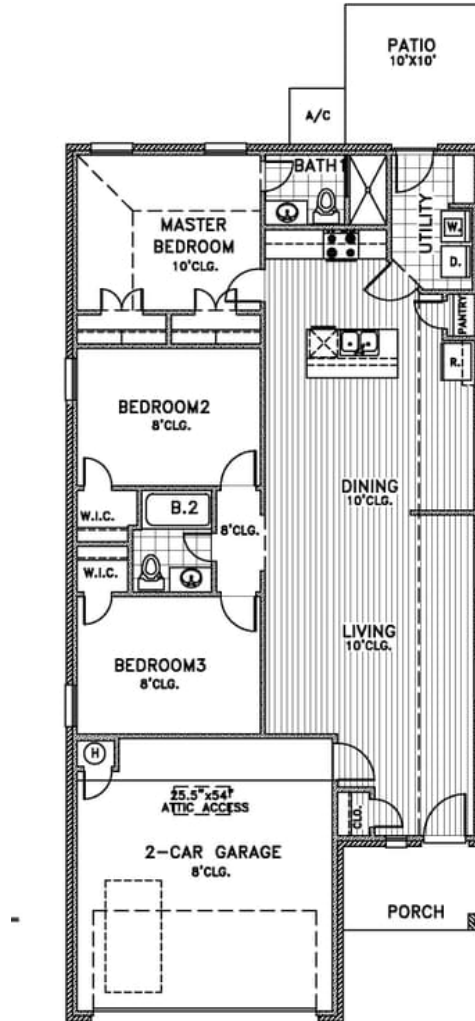

The availability and/or features of this plan are subject to change without prior notice. Price of this plan will vary at different communities. Please contact our New Home Consultant for details and available homes with this plan.





# Included Features

**Address:** 936 SW 139th Street **Price:** \$241,578

**Floor Plan:** Poppy

**Square Feet:** 1,361 (m.o.l.) **Bedrooms:** 3 **Bathrooms:** 2.0 **Garage:** 2 Car

## Bathroom

Price Pfister® bathroom faucet (satin nickel or oil rubbed bronze)  
Ceramic tile floor in baths

Fiberglass shower / tub combo in hall bath  
Tiled shower in master bath

## Interior Finishes

Interior doors (panel style may vary)  
Box rated for ceiling fans in all other bedrooms  
Pull-down attic access in garage (in single story plan)  
Ceiling fans in living room and master bedroom  
Filtrete™ Air Filtration Systems  
Finished 2-car garage with wind resistant steel insulated garage door  
2 Electrical outlets w/dual USB ports (in the kitchen & master bedroom) (permitted after 08/01/19)  
3 1/4" baseboards

Garage door opener with 2 remotes (2-car garages only)  
Insulated entry door (panel style may vary)  
Light fixture package (includes wiring & installation)  
Hand textured walls  
Raised 10' ceiling in living areas and master bedrooms (in single story plan)  
Overhead cabinet, shelf and clothing rod in utility room  
Combo flooring- Ceramic tile floors in select areas and wall-to-wall plush cut loop berber carpet with 1/2" 6 lb pad in select areas  
Luxury Vinyl Plank in the living room, dining, kitchen and hallways

## Energy-efficiency

97% efficient tankless water heater  
Low-e Thermalpane tilt-in vinyl windows with screen (U-Factors of .35 or less & SHGC Coefficient with argon gas of .26 or less)  
HERS Index Energy Efficiency Rating (every home is tested; score varies per plan & home permit date)  
R-15 blown-in insulation in external walls. Excludes garage  
R-8 Perimeter foam insulation under slab

Radiant Barrier Roof Decking  
R-8 Insulated and mastic sealed A/C ducts  
Polycel caulking around windows, doors and joints (energy efficient caulking package)  
R-19 batt insulation in sloped ceiling  
Eave roof ventilation  
Gas heating 96% high efficiency furnace and duct work  
R-44 blown-in insulation in attic

## Construction / Plumbing / Electric / Mechanical

Moisture Barrier that lays on top of foundation (homes permitted after 02/01/2020)  
Atlas HP42 130-MPH rated shingles  
Coefficient with argon gas of .26 or less  
Electric dryer connection in utility room  
Category 5 structured wiring  
Protective ground fault interrupter circuits  
Uponor AquaPEX tubing for water lines  
Copper electrical wiring

Air and moisture barrier DUPONT TYVEK HOMEWRAP with 10-year warranty  
Exterior 2 x 4 stud-grade lumber walls (16" on center)  
Heat-taped condensation lines (attic only)  
16 SEER electrical central air conditioning  
RG6 quad shield cable wiring (at least 4 cable outlets)  
Enhanced modified slab on grade

## Safety

Anchor bolts that secure perimeter walls to foundation  
Tornado Straps that secure perimeter walls to rafters/roof  
Installed smoke detectors  
Kwikset Smart Key locks and hardware  
ToughRock® Fireguard® 45 Gypsum Board sheetrock screwed to studs/walls (exception Barrel Ceilings)

ADT Command Panel Security System  
Oriented Strand Board (OSB) exterior walls  
Carbon Monoxide Sensor  
ToughRock® Fireguard® 45 Gypsum Board sheetrock screwed to studs/walls  
Plasma Air 600 series (homes framed after 02/01/2021)

## Exterior Finishes

Concrete patio (vary per plan)  
Full Sod (homes sold after 2/5/2021)  
Brick mailbox (may vary due to location of property)  
Guttering over entry and AC pad (vary per plan)  
Shutters and/or dormers (vary per plan)  
Brick on back of home  
Upgraded landscape package w/ stone border

8/12 roof pitch  
Minimum of 2 exterior waterproof electrical outlets  
Semi-gloss exterior paint  
Stone accents on exterior  
Two Woodford Freeze-Proof Exterior Water Spigots  
Upgraded glass front door

## Warranties

Manufacturer's limited appliance warranty  
RWC New Home limited 10-year warranty  
Builder's limited one-year warranty

Manufacturer's limited heating & cooling units warranty  
Termite company's warranty  
Manufacturer's limited lifetime shingle warranty

## Kitchen

1/3 horsepower sink garbage disposal  
3 cm granite or quartz kitchen countertops with tiled backsplash  
Samsung stainless steel dishwasher, over the range microwave and free-standing gas range (homes permitted after 5/1/2019)

Water line for refrigerator icemaker  
Custom cabinets  
8" deep under mount kitchen sink (stainless steel)  
1-hole Price Pfister kitchen faucet

**Buyer's Initials** \_\_\_\_\_ **Buyer's Initials** \_\_\_\_\_ **Seller's or its Representative's Initials** \_\_\_\_\_

Due to constant updates and revisions of our plans, your home may vary slightly from the designs features here. Please consult your New Home Consultant for details.

