

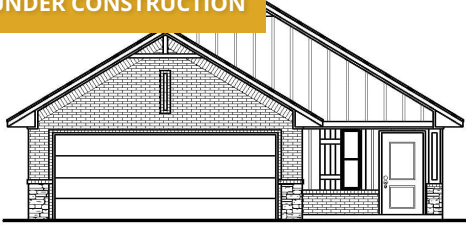

NEW HOME CONSULTANT
Holly McGowen
 (405) 229-7504 Cell Phone
 (405) 364-9999 Model Home

Community: Palermo Place
Model: 14112 Celeste Lane, Oklahoma City, OK
 73170

UNDER CONSTRUCTION



917 SW 139th Street
Oklahoma City, OK 73170

HOME PRICED AT
\$225,926

Price and availability are subject to change without prior notice. Accurate as of Feb 25, 2021.

- Floor Plan:** Poppy Elite
- Square Feet:** 1,361 (m.o.l.)
- Bedrooms:** 3
- Bathrooms:** 2.0
- Garage:** 2 Car

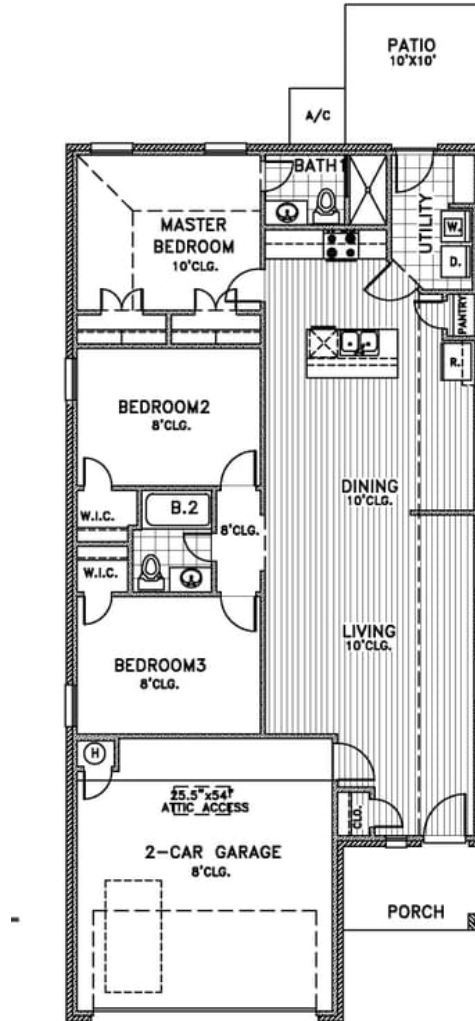

The availability and/or features of this plan are subject to change without prior notice. Price of this plan will vary at different communities. Please contact our New Home Consultant for details and available homes with this plan.





Included Features

Address: 917 SW 139th Street **Price:** \$225,926

Floor Plan: Poppy

Square Feet: 1,361 (m.o.l.) **Bedrooms:** 3 **Bathrooms:** 2.0 **Garage:** 2 Car

Bathroom

Price Pfister® bathroom faucet (satin nickel or oil rubbed bronze)
Ceramic tile floor in baths

Fiberglass shower / tub combo in hall bath
Tiled shower in master bath

Interior Finishes

Interior doors (panel style may vary)
Box rated for ceiling fans in all other bedrooms
Pull-down attic access in garage (in single story plan)
Ceiling fans in living room and master bedroom
Filtrete™ Air Filtration Systems
Finished 2-car garage with wind resistant steel insulated garage door
2 Electrical outlets w/dual USB ports (in the kitchen & master bedroom) (permitted after 08/01/19)
3 1/4" baseboards

Garage door opener with 2 remotes (2-car garages only)
Insulated entry door (panel style may vary)
Light fixture package (includes wiring & installation)
Hand textured walls
Raised 10' ceiling in living areas and master bedrooms (in single story plan)
Overhead cabinet, shelf and clothing rod in utility room
Combo flooring- Ceramic tile floors in select areas and wall-to-wall plush cut loop berber carpet with 1/2" 6 lb pad in select areas
Luxury Vinyl Plank in the living room, dining, kitchen and hallways

Energy-efficiency

97% efficient tankless water heater
Low-e Thermalpane tilt-in vinyl windows with screen (U-Factors of .35 or less & SHGC Coefficient with argon gas of .26 or less)
HERS Index Energy Efficiency Rating (every home is tested; score varies per plan & home permit date)
R-15 blown-in insulation in external walls. Excludes garage
R-8 Perimeter foam insulation under slab

Radiant Barrier Roof Decking
R-8 Insulated and mastic sealed A/C ducts
Polycel caulking around windows, doors and joints (energy efficient caulking package)
R-19 batt insulation in sloped ceiling
Eave roof ventilation
Gas heating 96% high efficiency furnace and duct work
R-44 blown-in insulation in attic

Construction / Plumbing / Electric / Mechanical

Moisture Barrier that lays on top of foundation (homes permitted after 02/01/2020)
Atlas HP42 130-MPH rated shingles
Coefficient with argon gas of .26 or less
Electric dryer connection in utility room
Category 5 structured wiring
Protective ground fault interrupter circuits
Uponor AquaPEX tubing for water lines
Copper electrical wiring

Air and moisture barrier DUPONT TYVEK HOMEWRAP with 10-year warranty
Exterior 2 x 4 stud-grade lumber walls (16" on center)
Heat-taped condensation lines (attic only)
16 SEER electrical central air conditioning
RG6 quad shield cable wiring (at least 4 cable outlets)
Enhanced modified slab on grade

Safety

Anchor bolts that secure perimeter walls to foundation
Tornado Straps that secure perimeter walls to rafters/roof
Installed smoke detectors
Kwikset Smart Key locks and hardware
ToughRock® Fireguard® 45 Gypsum Board sheetrock screwed to studs/walls (exception Barrel Ceilings)

ADT Command Panel Security System
Oriented Strand Board (OSB) exterior walls
Carbon Monoxide Sensor
ToughRock® Fireguard® 45 Gypsum Board sheetrock screwed to studs/walls
Plasma Air 600 series (homes framed after 02/01/2021)

Exterior Finishes

Concrete patio (vary per plan)
Full Sod (homes permitted after 2/5/2021)
Brick mailbox (may vary due to location of property)
Guttering over entry and AC pad (vary per plan)
Shutters and/or dormers (vary per plan)
Brick on back of home
Upgraded landscape package w/ stone border

8/12 roof pitch
Minimum of 2 exterior waterproof electrical outlets
Semi-gloss exterior paint
Stone accents on exterior
Two Woodford Freeze-Proof Exterior Water Spigots
Upgraded glass front door

Warranties

Manufacturer's limited appliance warranty
RWC New Home limited 10-year warranty
Builder's limited one-year warranty

Manufacturer's limited heating & cooling units warranty
Termite company's warranty
Manufacturer's limited lifetime shingle warranty

Kitchen

1/3 horsepower sink garbage disposal
3 cm granite or quartz kitchen countertops with tiled backsplash
Samsung stainless steel top control dishwasher, over the range microwave and free-standing gas range (homes permitted after 5/1/2019)

Water line for refrigerator icemaker
Custom cabinets
8" deep under mount kitchen sink (stainless steel)
1-hole Price Pfister kitchen faucet

Buyer's Initials _____ **Buyer's Initials** _____ **Seller's or its Representative's Initials** _____

Due to constant updates and revisions of our plans, your home may vary slightly from the designs features here. Please consult your New Home Consultant for details.

