

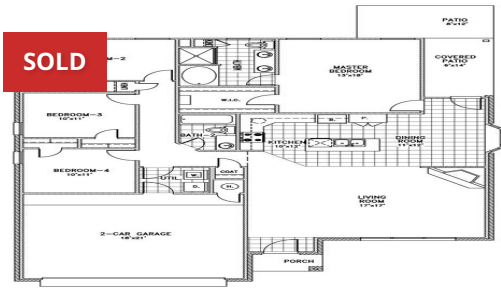

NEW HOME CONSULTANT
Audra Brown
 (918) 619-5354 Cell Phone
 (918) 832-0999 Model Home

Community: Southridge at Lantern Hill
Model: 6442 East 148th Street , Bixby, OK 74008



14741 S Lakewood Place
Bixby, OK 74008

SOLD

Price and availability are subject to change without prior notice. Accurate as of Oct 11, 2024.

From the Wellington Collection

Floor Plan: Jefferson
Square Feet: 1,740 (m.o.l.)
Bedrooms: 4
Bathrooms: 2.0
Garage: 2 Car

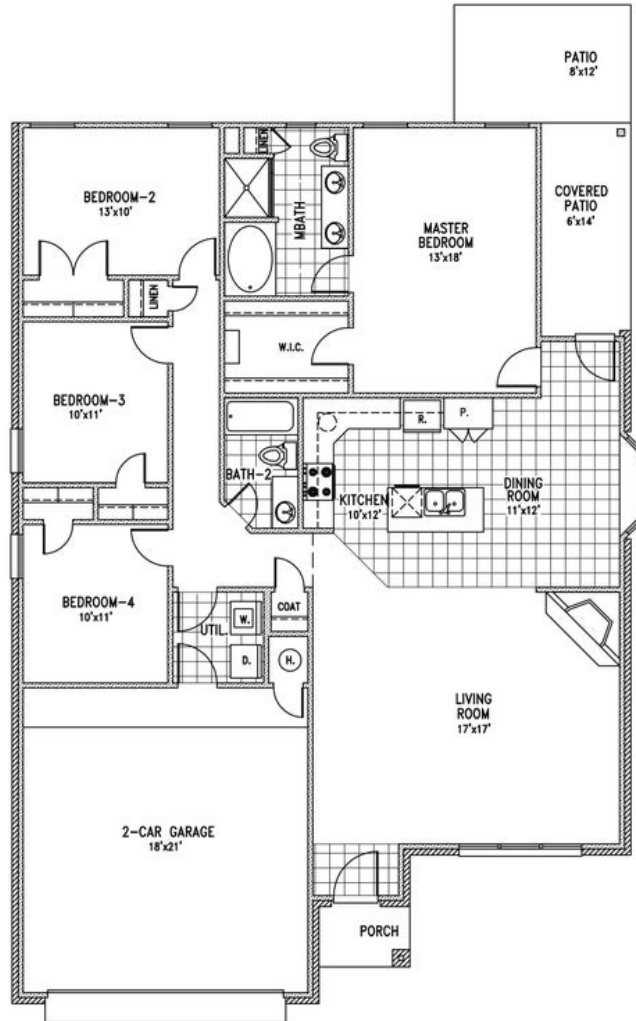



Included Features

Address: 14741 S Lakewood Place **Price:** \$222,252

Collection: The Wellington Collection **Floor Plan:** Jefferson

Square Feet: 1,740 (m.o.l.) **Bedrooms:** 4 **Bathrooms:** 2.0 **Garage:** 2 Car

Construction / Plumbing / Electrical / Mechanical

Copper electrical wiring
Category 5 structured wiring
Exterior 2 x 4 stud-grade lumber walls
16 SEER electrical central air conditioning
RG6 quad shield cable wiring (minimum of 4 cable outlets)

Copper electrical wiring
Uponor AquaPEX tubing for water lines
Electric dryer connection in utility room
Protective ground fault interrupter circuits
Stone trim on front of home per plan (upgraded stucco accent wall available)

Bathroom

Elongated toilets in bathrooms
3 cm granite vanity tops with ceramic undermount bowls
Garden tub and separate shower with glass doors and acrylic insert in Master Bath

Fiberglass shower/tub combo in Hall bathroom
Bathroom hardware in Brushed Nickel or Oil Rubbed Bronze

Inspections / Engineering

HERS Index energy efficiency rating performed twice by 3rd party licensed inspector (every home is tested; score varies per plan & home permit date)

Energy-efficiency

Eave roof ventilation
Radiant Barrier Roof Decking
Insulated and mastic sealed A/C ducts
R-19 Batt insulation in sloped ceiling
Polycel caulking around windows, doors and joints
R-44 Blown-in insulation in attic and RR-15 in exterior walls
HERS Index Energy Efficiency Rating (varies per plan & home permit date)

Premeter slab insulation
House wrap with moisture barrier
R-8 Perimeter foam insulation at slab
Gas heating 96% high efficiency furnace
Low-e Thermalpane tilt-in vinyl windows with screen
96% efficient gas tankless water heater (homes permitted after 4/15/19)

Safety

Oriented Strand Board (OSB) exterior walls
Tornado Straps that secure perimeter walls to rafters
Sheetrock screwed to studs/walls (except Barrel Ceilings)

Installed smoke & carbon monoxide detectors
Anchor bolts that secure perimeter walls to foundation

Exterior Finishes

Landscaping package
Concrete patio (varies per plan)
Three exterior waterproof electrical outlets
Brick mailbox with cast stone address block (may vary due to location of property)

Semi-gloss exterior paint
Two exterior frost proof water spigots
Guttering over AC pad and entry (varies per plan)
Brick exterior with brick ledge and siding on back with stone trim on front (varies per plan)

Two-car garage with insulated, wind-resistant steel panels, and garage door opener with two remote control openers

Warranties

Termite company's warranty
RWC New Home limited 10-year warranty
Manufacturer's limited appliance warranty
Manufacturer's limited heating & cooling units warranty

Builder's limited one-year warranty
Brick company's limited 100-year warranty
Manufacturer's limited lifetime shingle warranty

Buyer's Initials _____ **Buyer's Initials** _____ **Seller's or its Representative's Initials** _____

* Features subject to availability.

Due to constant updates and revisions of our plans, your home may vary slightly from the designs features here. Please consult your New Home Consultant for details.





Included Features

Address: 14741 S Lakewood Place **Price:** \$222,252

Collection: The Wellington Collection **Floor Plan:** Jefferson

Square Feet: 1,740 (m.o.l.) **Bedrooms:** 4 **Bathrooms:** 2.0 **Garage:** 2 Car

Interior Finishes

Full Blinds
Orange peel texture walls
Insulated entry door (panel style may vary)
Box rated for ceiling fan in all other bedrooms
Gas log fireplace or modern style electric fireplace
Pull-down attic access in garage (in single story plan)
Custom light fixture package (includes wiring & installation)

Paint grade baseboards
Paint grade crown molding
Ceiling fans in living room and master bedroom
Bullnose corners in common areas (varies per plan)
Wall-to-wall plush cut berber carpet with 1/2" 6lb pad
Raised 10' ceiling in living areas (in single story plan)
Ceramic tile floor in entry, kitchen, dining room, bathrooms and utility room

Kitchen

Gas stub in kitchen
Water line for refrigerator icemaker
USB outlet in kitchen (house permitted after 5/1/2017)
Stainless steel gas freestanding range, over the range microwave and dishwasher (homes permitted after 4/15/19)

1-hole kitchen faucet
Pendant lights over bar (varies per plan)
3 cm granite or quartz kitchen countertops with travertine backsplash

Buyer's Initials _____ **Buyer's Initials** _____ **Seller's or its Representative's Initials** _____

* Features subject to availability.

Due to constant updates and revisions of our plans, your home may vary slightly from the designs features here. Please consult your New Home Consultant for details.

